

DETAIL A
Gripper Interface Ring

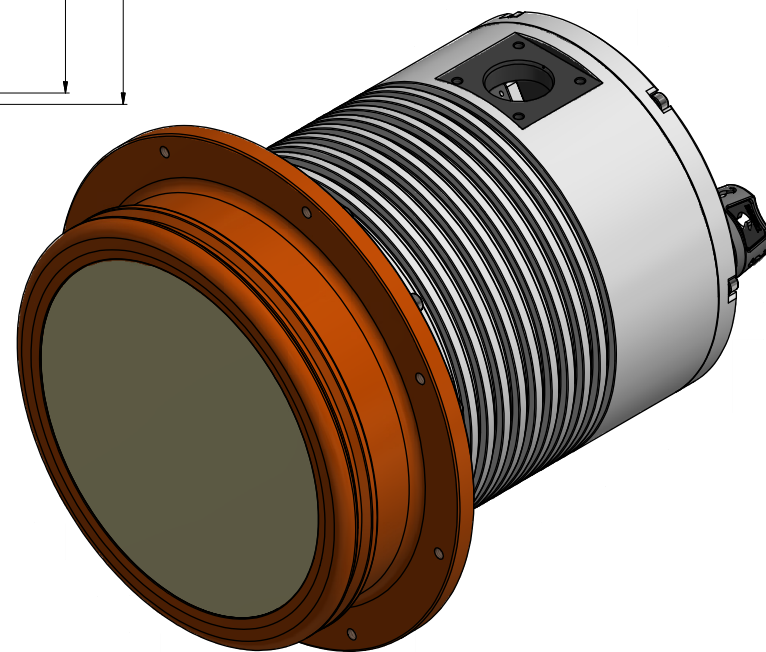
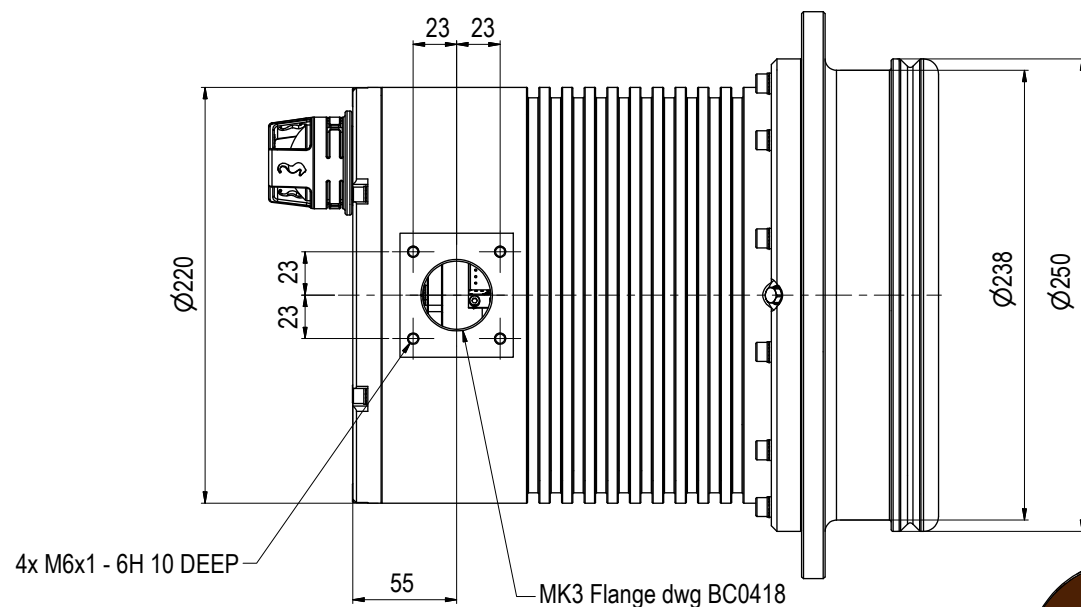

NOTE: 1
STANDARDS:
API17H, API17F, TR1231, TR1233

NOTE: 2
PROPERTIES:
Application: Permanent
Design Water Depth: 3000
Weight in Air: 43,1 kg
Volume: 7,68 dm³
Submerged Weight: 35,2 kg

NOTE: 3
ADDITIONAL INFORMATION:
2,5kW Inductive Connector for wireless transfer of power and communication. Designed for installation in Blue Logic's Charging Station, for charging of underwater intervention drones.
Metallic parts in Super Duplex suitable for permanent installation.
The Connector is made SWiG compatible and fully compliant to API17F, API 17H, and to Equinor TR1231 Appendix D.
A new MK3 Flange Interface for Pressure Balanced Oil Filled (PBOF) Hose attachment has been included and qualified. This makes it possible to interface any type of equipment.

Input Volt 400 VDC +/- 10%
Output Volt 325VDC +/-5%
Output current 7,7A
Efficiency @2,0kW 91%
Start-up time 90 sec.

Connector shall NOT be connected to a CP-System as described in Installation Manual, ref.: 500419-TD-0015

NOTE 4
Available Interfaces (can be configured). See Datasheet for details, ref.: 500419-TD-0016

ID	Description
1	+325VDC OUT
2	GND – 325VDC (0V)
3	Chassis
4	RS232/RS485 TX/A EXT COM
5	RS232/RS485 RX/B EXT COM
6	RS232/RS485 GND EXT COM
7	L3-G Eth1 TX+ Config.
8	L3-H Eth1 TX- Config.
9	L3-K Eth1 RX+ Config.
10	L3-L Eth1 RX- Config.
11	L3-E Eth2 TX+ Transparent
12	L3-F Eth2 TX- Transparent
13	L3-I Eth2 RX+ Transparent
14	L3-J Eth2 RX- Transparent

								Unless Noted Otherwise:	Dwg Scale: NTS	Drawing title: F45-140 Pri-Flange Perm 2,5kW 400VDC Ethernet			
04	26.5.2023	7-IFC (Issued for Construction)		WTJ	BNE	HSE		Dim. Tol: NS-ISO 2768-1	Dwg Proj: 				
03	9.2.2023	7-IFC (Issued for Construction)		WTJ	HSE	BNE		Roughness: Ra	Dwg Format: A3				
02	8.12.2022	2-IFT (Issued for Tender)		WTJ	SEA	WTJ		Fillet Rad: Corner Rmax:	Break Edges: (R. Alt. 45°) R= 0.1-0.5	Drawing number: BB7133	Article number:		Rev. 04
Rev.	Date	Reason for issue	Revision change	Made	Chk'd	Appr.							

This Drawing is the Property of Subsea USB AS © and must Not be Loaned, Reproduced or Transferred to others without written Permission of an Authorized Representative of Subsea USB AS