

NOTE: 1  
DESIGN CODE:  
API 6A/ISO 10423 PSL 3G

NOTE: 2  
TECHNICAL CLASSIFICATION:  
Article Type: 003-Valve Stabs  
Main Group: 3.05. Ø100-Valvestab  
Intermediate Group: 3.35.01. Stab  
Sub Group: 3.35.80.2. Dual

NOTE: 3  
INTERFACE INFORMATION:  
Pressure Rating Bar: 520  
Design Water Depth: N/A  
Material: Long-term  
Weight in Air: 28,7 kg  
Volume: 4,07 dm<sup>3</sup>  
Submerged Weight: 24,51 kg  
Surface Area: 8315 cm<sup>2</sup>  
Hydraulic: MP 3/4"  
Mechanical: N/A  
Electrical: N/A  
Com. & Protocol: N/A

NOTE: 4  
ADDITIONAL INFORMATION:  
Ø100 Dual Port Valve Stab for Long-term subsea use (25 years).  
Hydraulic interface 3/4" Medium Pressure.  
Designed for high CO<sub>2</sub> level and H<sub>2</sub>S content up to 10ppm.  
Internal minimum flow diameter 13.1mm

Note!  
This VStab is only compatible with dual port Vstab receptacles. Mating of  
Vstabs and Vstab receptacles with different number of ports may cause  
injuries, equipment damage and spill of fluid.

NOTE 5  
Clockwise to Close

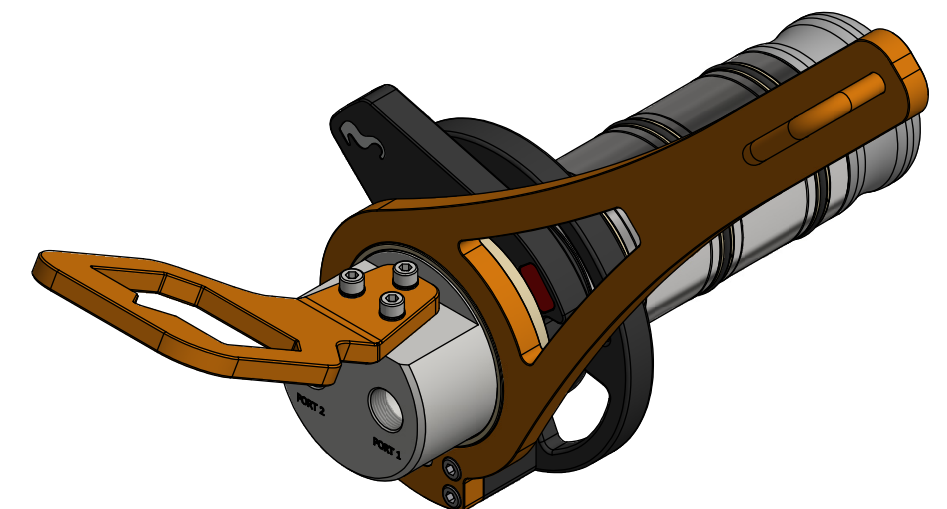
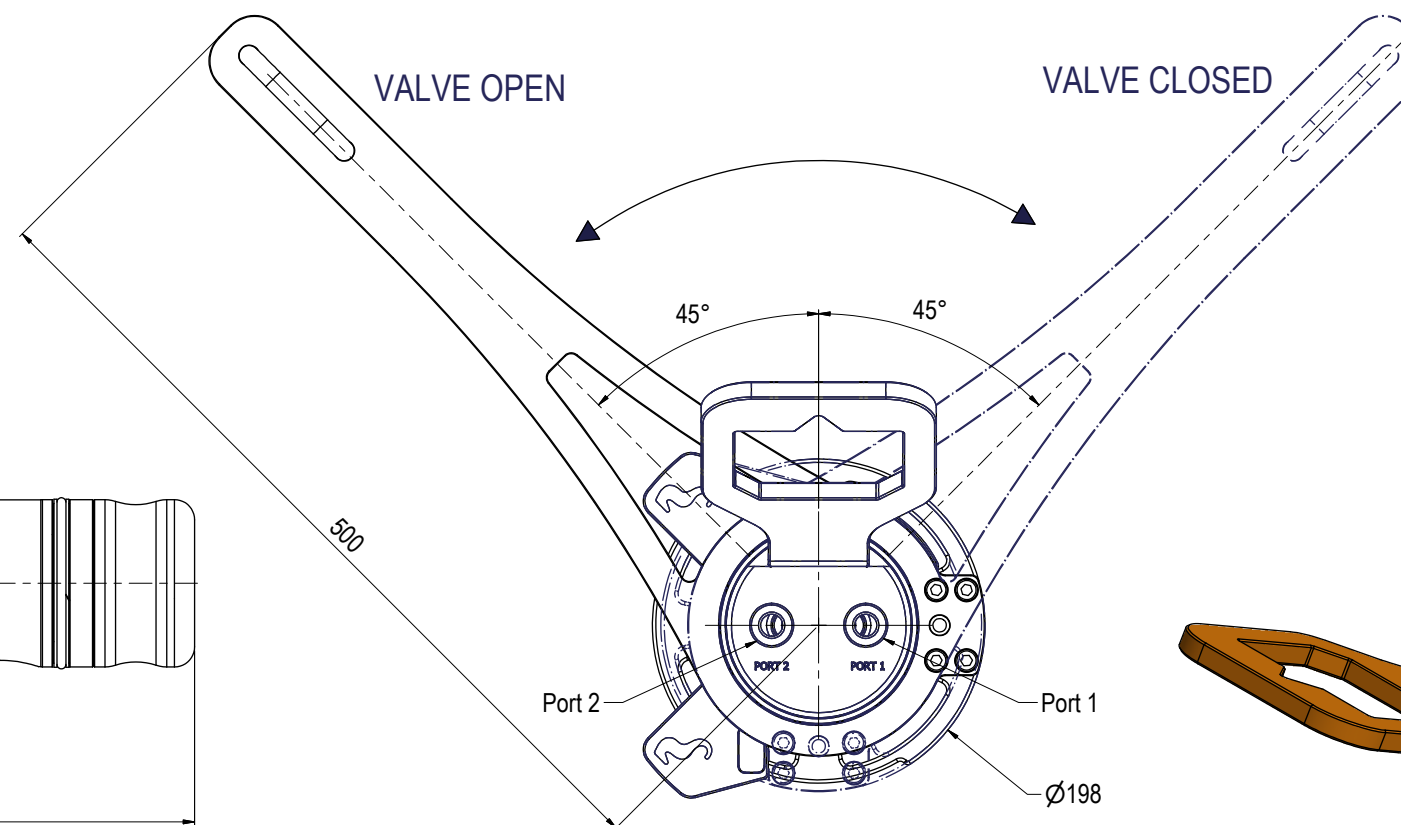
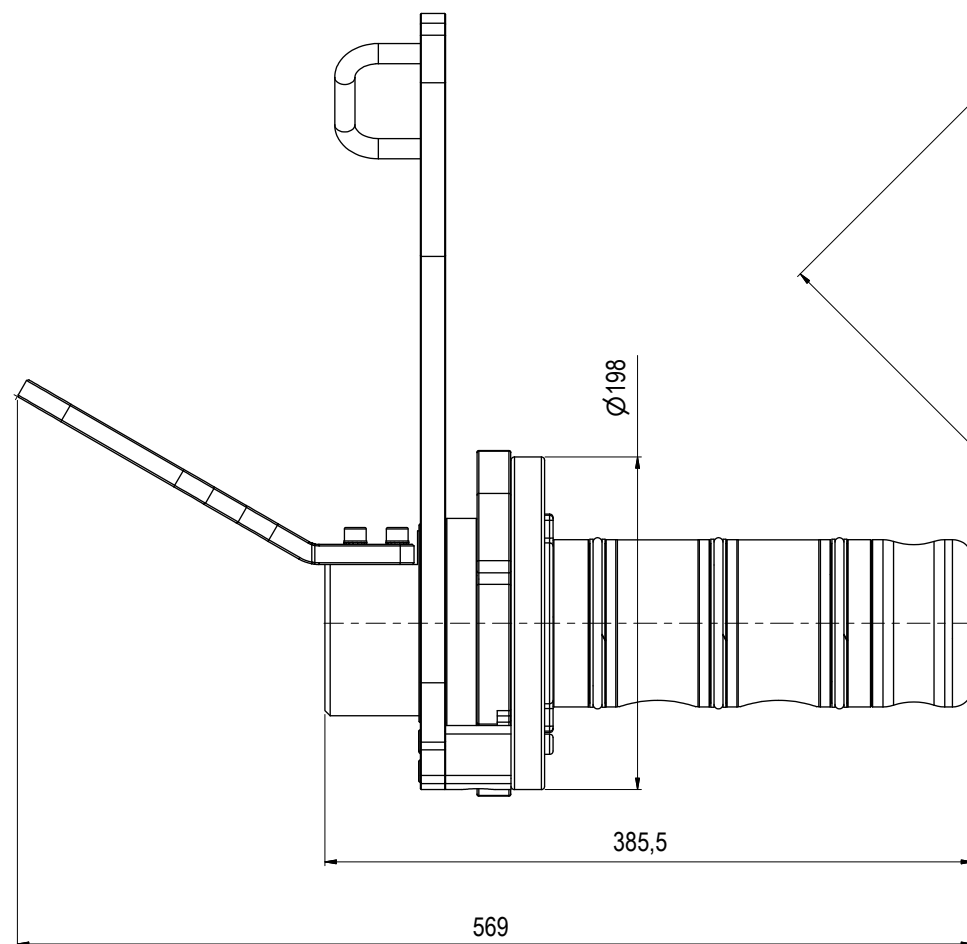

09	19.6.2019	9-IFU (Issued for Use)		WTJ	LGH	WTJ
08	25.3.2019	9-IFU (Issued for Use)		WTJ	EKJ	LGH
07	5.3.2019	9-IFU (Issued for Use)		WTJ	LGH	WTJ
06	1.3.2019	9-IFU (Issued for Use)		WTJ	LGH	WTJ
Rev.	Date	Reason for issue	Revision change	Made	Chk'd	Appr.

**BLUE LOGIC**

Dwg Scale:  
NTS  
Dwg Proj:  
Dwg Format:  
A3

Drawing title:  
Ø100 DP VStab 7,5k Long-term MP 3/4"

Drawing number:  
BB1329

Rev.  
09