

NOTE: 1  
DESIGN CODE:  
NS-EN 13445:2009 / ISO 13628-8

NOTE: 2  
TECHNICAL CLASSIFICATION:  
Article Type: 003-Valve Stabs  
Main Group: 3.07. Dual Bore-Valvestab  
Intermediate Group: 3.42.1. Stab  
Sub Group: 3.42.102.6. Hexa

NOTE: 3  
INTERFACE INFORMATION:  
Pressure Rating Bar: 690  
Material: Semi Permanent  
Weight: 9,3 kg  
Volume: 1,26 dm^3  
Surface Area: 3704 cm^2  
Hydraulic: 3/8" BSP  
Mechanical: D-Handle  
Electrical: N/A  
Com. & Protocol: N/A

NOTE: 4  
ADDITIONAL INFORMATION:  
Male Valve Stab with 6 individual hydraulic lines. Designed for short term submersion in intervention applications.  
This valve stab is equipped with a key system (blue key) and can only be inserted and mated with a receptacle with similar blue key. The stab will also fit into standard receptacles without key.  
The Valve Stab hydraulic connection system is a pressure balanced hydraulic connector system with integrated ball valves in all ports on both the male and female side. Can be connected and disconnected with full system pressure, water ingress and pollution to sea during connection and disconnection is negligible.  
For more information - request usermanual 600142-TD-0001.

NOTE: 5  
SPAREPARTS:  
<http://e-sea.bluelogic.no/main.aspx?page=article&artno=BB1053>

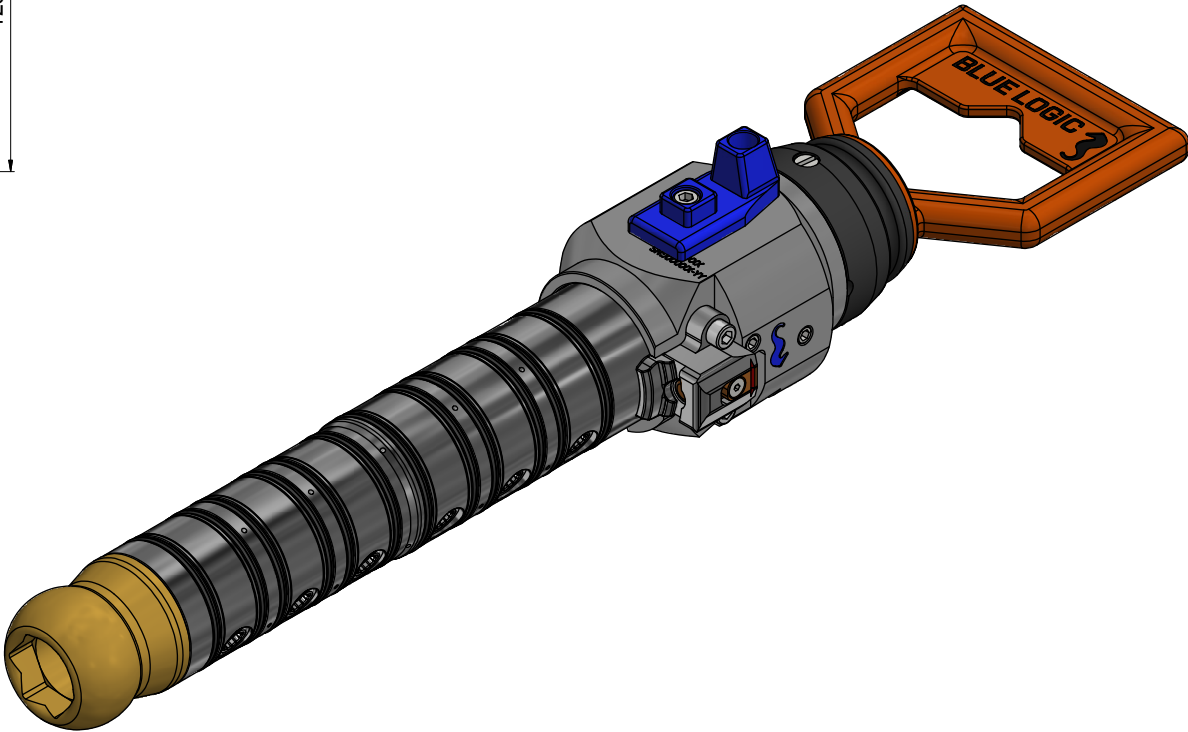

WEB REFERENCE LIST					
ITEM	QTY	PART No.	TITLE	WEBLINK	
1	1	BA9212	Key Blue for Stab & Handle Interface	<a href="http://e-sea.bluelogic.no/main.aspx?page=article&amp;artno=BA9212">http://e-sea.bluelogic.no/main.aspx?page=article&amp;artno=BA9212</a>	
2	1	BA7469	Ø55/Ø57 HP VStab 10k Semi Perm BSP 3/8" Double Seal	<a href="http://e-sea.bluelogic.no/main.aspx?page=article&amp;artno=BA7469">http://e-sea.bluelogic.no/main.aspx?page=article&amp;artno=BA7469</a>	
3	2	100363	Bolt		
04	1.2.2017	9-IFU (Issued for Use)		HNJ	WTJ
03	1.11.2016	9-IFU (Issued for Use)		WTJ	LGH
02	24.5.2016	9-IFU (Issued for Use)		WTJ	LAE
01	31.3.2016	2-IFT (Issued for Tender)		WTJ	HSE
Rev.	Date	Reason for issue		Made	Chk'd
		Revision change		Appr.	



Dwg Scale: NTS	Drawing title: Ø55/Ø57 HP VStab with Blue Key
Dwg Proj: A3	
Dwg Format: A3	
Drawing number: BA8371	Rev. 04