

NOTE: 1
DESIGN CODE:
NS-EN 13445:2009 / ISO 13628-8

NOTE: 2
TECHNICAL CLASSIFICATION:
Article Type: 003-Valve Stabs
Main Group: 3.07. Ø55/Ø57-Valvestab
Intermediate Group: 3.42.01. Stab
Sub Group: 3.42.102.6. Hexa

NOTE: 3
INTERFACE INFORMATION:
Pressure Rating Bar: 690
Material: Long-term
Weight: 9,2 kg
Volume: 1,25 dm^3
Surface Area: 3501 cm^2
Hydraulic: 3/8" BSP
Mechanical: D-Handle
Electrical: N/A
Com. & Protocol: N/A

NOTE: 4
ADDITIONAL INFORMATION:
Male Valve Stab with 6 individual hydraulic lines. Designed for short term submersion in intervention applications.
This valve stab can be equipped with a key system and can only be inserted and mated with a receptacle with similar key.
The Valve Stab hydraulic connection system is a pressure balanced hydraulic connector system with integrated ball valves in all ports on both the male and female side. Can be connected and disconnected with full system pressure, water ingress and pollution to sea during connection and disconnection is negligible.
For more information - request usermanual 600142-TD-0001.

NOTE: 5
SPAREPARTS:
<http://e-sea.bluelogic.no/main.aspx?page=article&artno=BB1053>

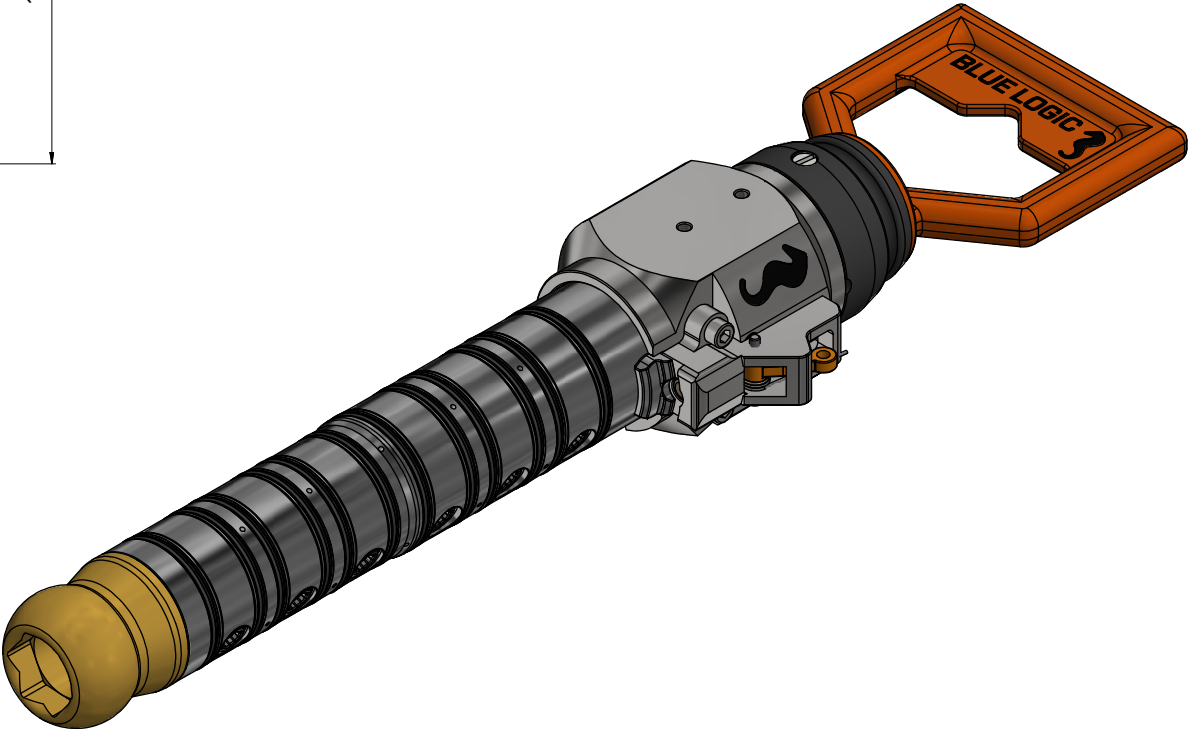
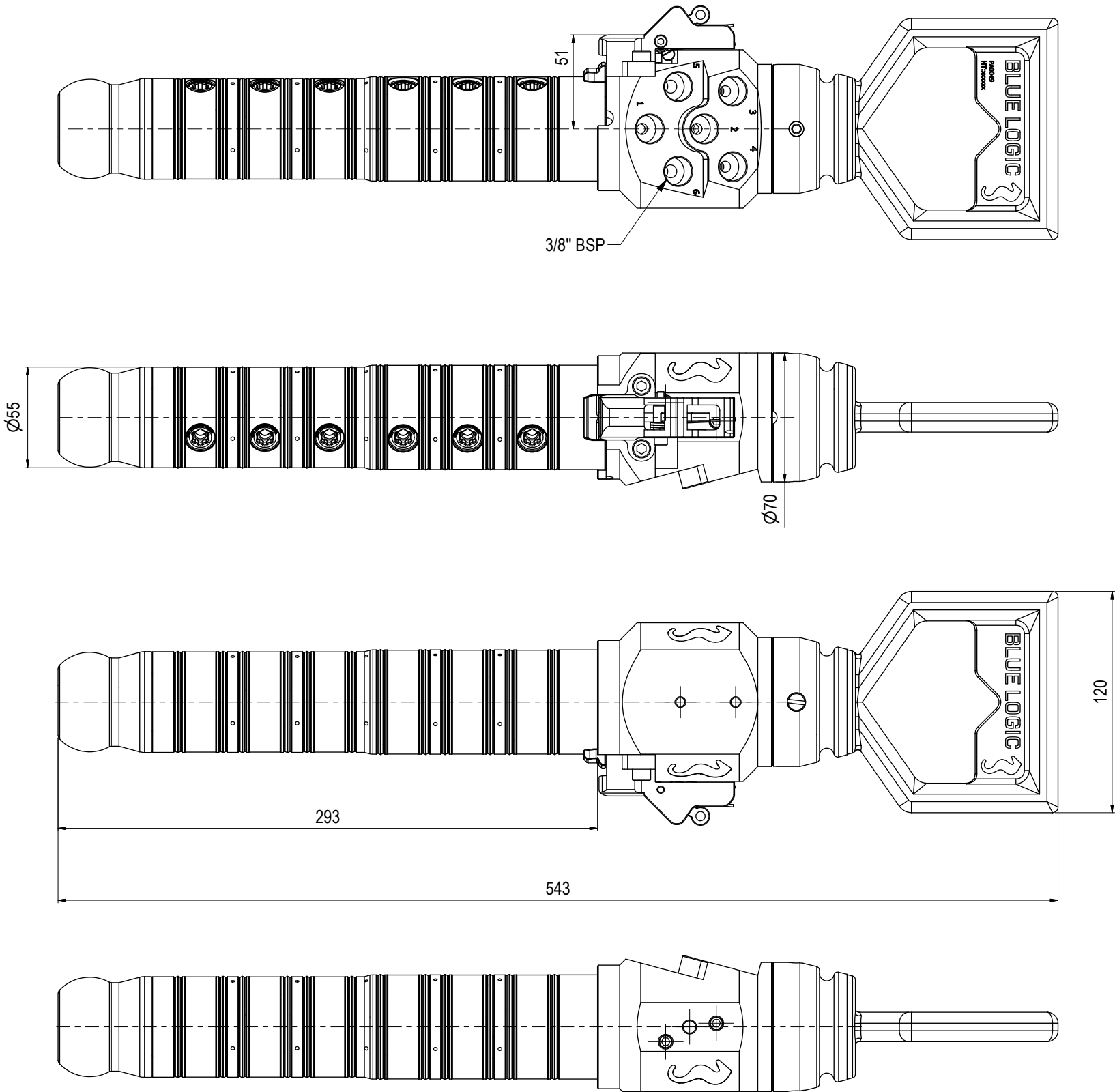

22	9.10.2023	9-IFU (Issued for Use)		WTJ	LGH	WTJ	<div>BLUE LOGIC</div>	Dwg Scale: NTS	<div>Dwg Proj:</div>	Drawing title: Ø55/Ø57 HP VStab 10K Long-term BSP 3/8" Double Seal	Drawing number: BA7469	Rev 22
21	12.9.2023	9-IFU (Issued for Use)		WTJ	LGH	WTJ		Dwg Format: A3				
20	31.5.2023	9-IFU (Issued for Use)		WTJ	LGH	WTJ						
19	30.11.2022	9-IFU (Issued for Use)		WTJ	TAN	WTJ						
Rev.	Date	Reason for issue	Revision change	Made	Chk'd	Appr.						