

NOTE: 1
DESIGN CODE:
NS-EN 13445:2009 / ISO 13628-8

NOTE: 2
TECHNICAL CLASSIFICATION:
Article Type: 003-Valve Stabs
Main Group: 3.07. Dual Bore-Valvestab
Intermediate Group: 3.42.1. Stab
Sub Group: 3.42.102.6. Hexa

NOTE: 3
INTERFACE INFORMATION:
Pressure Rating Bar: 690
Material: Semi Permanent
Weight: 9,3 kg
Volume: 1,26 dm³
Surface Area: 3696 cm²
Hydraulic: 3/8" BSP
Mechanical: D-Handle
Electrical: N/A
Com. & Protocol: N/A

NOTE: 4
ADDITIONAL INFORMATION:
Male Valve Stab with 6 individual hydraulic lines. Designed for short term submersion in intervention applications.
This valve stab is equipped with a key system (white key) and can only be inserted and mated with a receptacle with similar white key. The stab will also fit into standard receptacles without key.
The Valve Stab hydraulic connection system is a pressure balanced hydraulic connector system with integrated ball valves in all ports on both the male and female side. Can be connected and disconnected with full system pressure, water ingress and pollution to sea during connection and disconnection is negligible.
For more information - request usermanual 600142-TD-0001.

NOTE: 5
SPAREPARTS:
<http://e-sea.bluelogic.no/main.aspx?page=article&artno=BB1053>

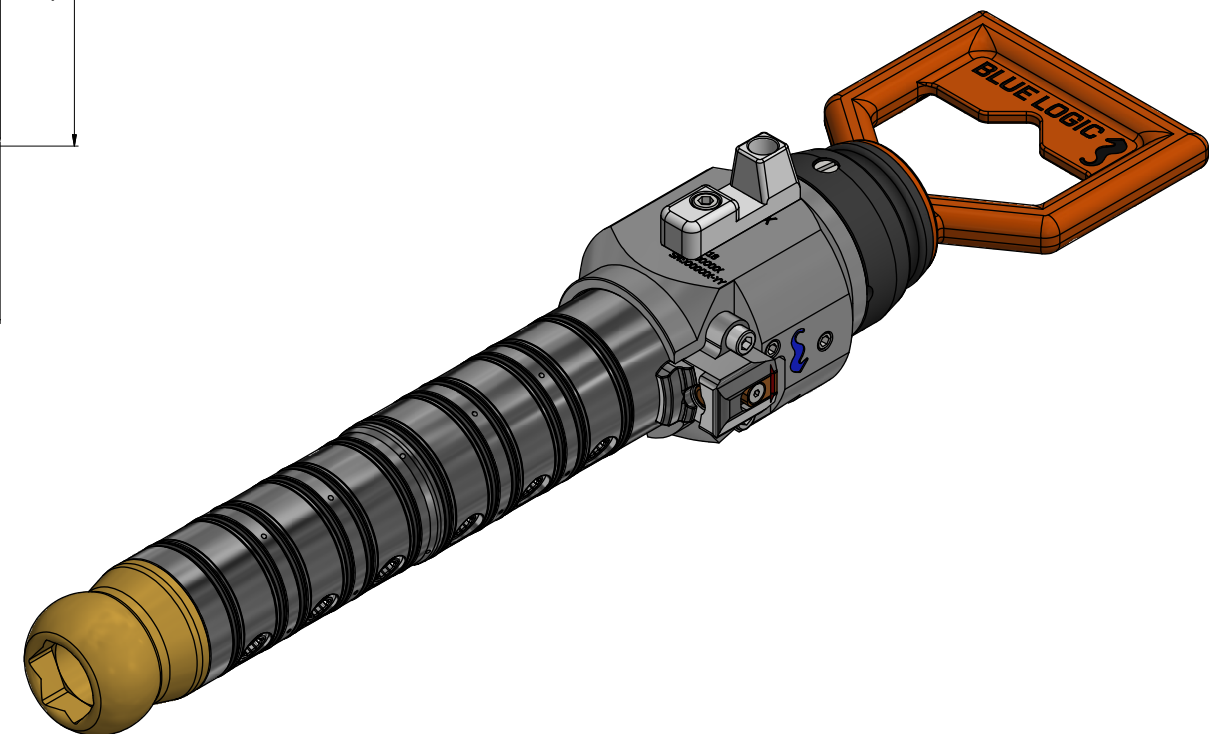

WEB REFERENCE LIST				
ITEM	QTY	PART No.	TITLE	WEBLINK
1	1	BA9090	Key White for Stab wTool Interface V2	http://e-sea.bluelogic.no/main.aspx?page=article&artno=BA9090
2	1	BA7469	Ø55/Ø57 HP VStab 10k Semi Perm BSP 3/8" Double Seal	http://e-sea.bluelogic.no/main.aspx?page=article&artno=BA7469
3	2	100363	Bolt	
05	1.2.2017	9-IFU (Issued for Use)		HNJ WTJ WTJ
04	1.11.2016	9-IFU (Issued for Use)		WTJ LGH WTJ
03	24.5.2016	9-IFU (Issued for Use)		WTJ LAE WTJ
02	23.5.2016	2-IFT (Issued For Tender)		WTJ LAE WTJ
Rev.	Date	Reason for issue	Revision change	Made Chk'd Appr.

BLUE LOGIC

Dwg Scale:
NTS
Dwg Proj:
Dwg Format:
A3

Drawing title:
Ø55/Ø57 HP VStab with White Key

Drawing number:
BA8369

Rev.
05