

NOTE: 1  
DESIGN CODE:  
NS-EN 13445

NOTE: 2  
TECHNICAL CLASSIFICATION:  
Article Type: 003-Valve Stabs  
Main Group: 3.03. Ø55-Valvestab  
Intermediate Group: 3.12.02. Receptacle  
Sub Group: 3.12.69.6. Hexa

NOTE: 3  
INTERFACE INFORMATION:  
Pressure Rating Bar: 250  
Design Water Depth: 3000m  
Material: Intervention  
Weight in Air: 12,4 kg  
Volume: 2,82 dm<sup>3</sup>  
Submerged Weight: 9,5 kg  
Surface Area: 5858 cm<sup>2</sup>  
Hydraulic: 1/2" BSPx2 - 3/8" BSPx4  
Mechanical: N/A  
Electrical: N/A  
Com. & Protocol: N/A

NOTE: 4  
SPAREPARTS:  
BB1690

NOTE: 5  
ADDITIONAL INFORMATION:  
This VStab Receptacle is only compatible with hexa port Vstab with 2 off 1/2" BSP ports and 4 off 3/8" BSP ports. Mating of Vstabs and Vstab Receptacles with different number of ports may cause injuries, equipment damage and spill of fluid.

Usermanual: 600112-TD-0003

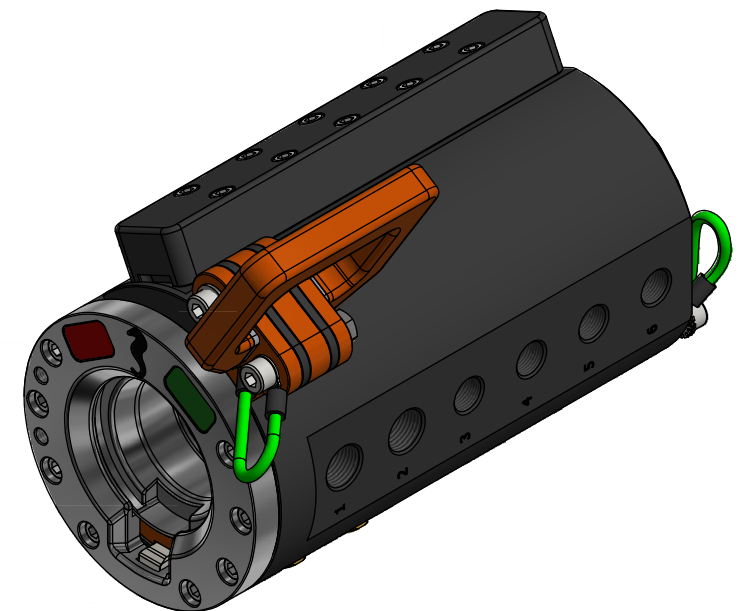

04	30.11.2023	9-IFU (Issued for Use)		WTJ	LGH	WTJ		Dwg Scale: NTS	Drawing title: Ø55 HP VStab Rec 250Bar Int Comp Mani BSP1/2"x2-BSP3/8"x4	Drawing number: BB3904	Rev. 04
03	24.2.2021	9-IFU (Issued for Use)		WTJ	LGH	WTJ		Dwg Proj:			
02	20.4.2020	9-IFU (Issued for Use)		WTJ	TBA	LGH		Dwg Format: A3			
01	3.10.2019	2-IFT (Issued for Tender)		WTJ	HNJ	WTJ					
Rev.	Date	Reason for issue	Revision change	Made	Chk'd	Appr.					